

FORM A - AREA SURVEY

MASSACHUSETTS HISTORICAL COMMISSION
Office of the Secretary, State House, Boston

1440-1453; 2270-2272

Form numbers in this area

HP-12 to HP-28

Area no.

HS



Salem

of area (if any) Federal Street districtral date or period 19th century, esp.third quarter

ea uniform (explain):

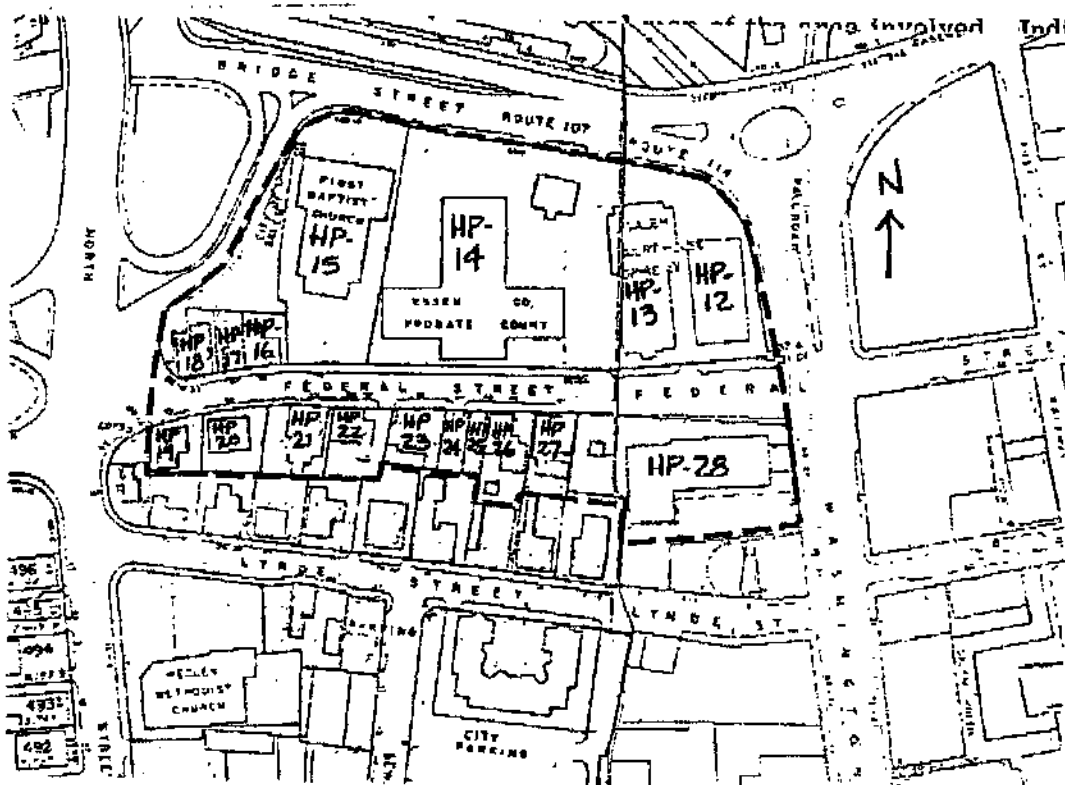
le? compatible mixndition? generally goodse of ownership? public & privatee? residential & institutional

Indicate any historic
using corres-
and indicate north.

DO NOT WRITE IN THIS SPACE
USGS Quadrant

MHC Photo no. _____

6. Recorded by A. CrumpOrganization Salem Redevelopment AuthorityDate November 1979

UTM References: A-19/

(over)

7. Historical data. Explain the historical/architectural importance of this area.

The block of Federal Street between Washington and North Streets is set apart from the rest of the street; on the east by the width of Washington Street and urban renewal clearance, and on the west, by a sharp bend in the course of the street coupled with a change to a more uniform residential character. The Federal Street District is therefore a self-contained block, characterized by contrasts of scale, architectural style and use which successfully synthesize into a single entity. No voids or intrusions disrupt the integrity of the district.

The first phase of development of the block was predominantly residential, as was most of downtown Salem. However, by 1810 both churches in the district were occupying their present sites, introducing the institutional character that dominates the block today. The Tabernacle Church of 1923 (HP-26), facing the corner of Washington Street, postdates the rest of the district, but a Congregational church has stood on that site since 1777. The First Baptist Church of 1805 (HP-15), near the other end of the district, is the oldest brick meetinghouse in Salem, and one of only fifty brick structures that stood in the city in 1806. The original Federal design was overlaid with Italianate detail in 1850, integrating the building into the predominantly mid-century character of the district. Three of the twelve houses on the block also represent this early period of development: the Georgian house at number 47 (HP-24), the small Federal house at number 60 (HP-17), and a Greek Revival duplex at 55-57 Federal Street (HP-22).

In 1841, a new granite Essex County Courthouse (HP-12) was built on the north corner of Washington Street. It was followed twenty years later by a red brick Superior Courthouse (HP-13) which was in turn enlarged and remodelled in 1889. Complementary residential development progressed simultaneously, and the district's residential character reflects the popular styles of the mid-19th century. Three handsome Mansard houses (HP-20, 23, 26) in particular translate the monumentality of the courthouses into domestic terms, and establish a dynamic interrelationship.

Five houses between the Superior Courthouse and the First Baptist Church were cleared to make room for a new Registry of Deeds (HP-14) in 1909. Construction of the Registry enhanced the dichotomy of scale already evident on the street. It also marked the close of development of the street, except for the replacement of the Tabernacle Church with a new structure of similar size and scale.

The contrast of the monumental institutional buildings on the north side of the street with the row of houses facing them defines the character of the district. Among both groups, however, a diversity of styles is represented. The Federal-Italianate hybrid style of the First Baptist Church, combined with the Greek Revival, 8. Bibliography and/or references such as local histories, deeds, assessor's records, early maps, etc.

Essex County Registry of Deeds

Essex Institute research files

Historic Salem Inc. research files

Hopkins, G.M. & Co.: Atlas of the City of Salem, 1874.

McIntyre, H.: Map of the City of Salem, 1851.

Salem Gazette, February 4, 1806 and March 30, 1850.

Salem Register, January 2, 1806 and August 26, 1850.

Sanborn Map Co.: Atlas of the City of Salem, 1906, corrected to 1929.

UNITED STATES DEPARTMENT OF THE INTERIOR
NATIONAL PARK SERVICE

RECEIVED

DATE ENTERED

**NATIONAL REGISTER OF HISTORIC PLACES
INVENTORY -- NOMINATION FORM**

CONTINUATION SHEET Federal Street ITEM NUMBER A PAGE 10

omanesque Revival and Classical Revival courthouses, represent a broad range of 19th century styles interpreted for institutional use.

he residential buildings demonstrate a similar variety of 19th century styles, unified by a consistency of design quality. All are ambitious vernacular examples of their styles, expressing understanding and confidence without innovation. The Nathaniel Readwell House at number 63 (HP-20) is especially noteworthy for competent execution of a sophisticated concept, in exceptionally well preserved condition.

This district is an expansion of a district containing only the three Essex County buildings that was listed on the National Register in 1976. Listing of the larger district will better protect the environment of the courthouses, as well as provide an increased understanding of their context.

ip-12: Old Essex County Courthouse (1841; Richard Bond)

This distinguished granite Greek Revival building was listed on the National Register in 1976.

BP-13: Essex County Superior Courthouse (1862, 1889; Enoch Fuller, and Wheelwright and Northend)

Originally Italianate in style, the present appearance of this red brick building trimmed in brownstone dates from its remodelling in the Romanesque Revival style. It was listed on the National Register in 1976.

HP-14: Essex County Registry of Deeds (1909; Clarence H. Blackall): This monumental granite Classical Revival Building was listed on the National Register in 1976. The 1979 addition to Probate Court is a 5-story concrete and glass edifice containing the Essex County Administration and Registry of Deeds offices as well as other Court functions. The building was designed by Phineas Alpers Inc. Construction costs was approximately \$2.8 million.

HP-15: First Baptist Church (1805, 1850)

HP-15: First Baptist Church (1805, 1850)

The present appearance of this handsome brick meetinghouse reflects the cosmetic alterations made in 1850 in a rusticated Italianate manner, as well as revealing the original Federal-style form of the structure. The pedimented facade is dominated by a projecting pavilion that expresses the narthex. Its three bays are articulated as an English basement containing three identical entrances framed in heavy rusticated brownstone. A belt course separates this basement from a principal story composed of tall arched windows capped by drip-molded brownstone. A lunette window is the centerpiece of the strongly projecting modillioned pediment, which is echoed in the visible outline of the sanctuary wall some ten feet behind it. An elaborate steeple was taken down earlier in this century. The building is further distinguished by its siting, placed seventy feet back on its lot with a pleasant treed lawn separating the church from its neighbors. The meetinghouse was recorded as one of only fifty brick buildings standing in Salem in 1806. Despite

0.741

UNITED STATES DEPARTMENT OF THE INTERIOR
NATIONAL PARK SERVICE

NATIONAL REGISTER OF HISTORIC PLACES
INVENTORY -- NOMINATION FORM

FOR NPS USE ONLY

RECEIVED

DATE ENTERED

CONTINUATION SHEET Federal Street ITEM NUMBER A PAGE 11

rare example of the expression of this style in public buildings, and effectively complements the array of institutional styles presented by the Essex County buildings.

HP-16: 58 Federal Street (c. 1850)

A vernacular five-bay, two-story center entry Greek Revival house, with three pedimented dormers facing the street, and a typically modest frontispiece of entablature and pilasters. An indication of the newer Italianate style can be seen in diminutive brackets punctuating the cornice.

HP-17: 60 Federal Street (c. 1810)

A simple Federal cottage two stories high and squarely proportioned, with a three-bay facade and shallow hip roof. The single story entrance porch is recessed at the left corner of the facade, and screened by latticework.

HP-18: 62 Federal Street (c. 1900)

This two-story vernacular Colonial Revival house has an L-shaped plan, with the entrance located at the inside corner, beneath a projected hexagonal oriel. A bow window forms the end wall facing the street. The oriel and second level of the bow front are clad with shingles, contrasting with the clapboard walls on the rest of the building.

HP-19: 65 Federal Street (1856)

This two-story, five-bay Bracketed-Italianate house sits with its gabled end wall on the street, and its hooded center entrance facing the side yard. The bracketed door hood and paired brackets below the eaves are the only stylistic elements that are visible despite aluminum siding.

HP-20: 63 Federal Street (1875)

This distinguished two-story, three-bay Mansard house is representative of the high quality of local expressions of this style. Its facade is clad with scored flush boards in imitation of ashlar. A Neo-Grecque-inspired entry portico crowned with a pedimented oriel focuses attention on the center entry. Further enrichment is provided by pedimented lintels on the flanking first story windows, and segmentally arched dormers which interrupt the projecting bracketed cornice with their volutes. The original cast iron fence completes the well preserved character of the house.

HP-21: 59 Federal Street (c. 1850)

An unpretentious Bracketed house two stories high with a tall gable facing the street. The three-bay facade is weighted to the left by a side-hall entrance sheltered by a bracketed porch.

UNITED STATES DEPARTMENT OF THE INTERIOR
NATIONAL PARK SERVICE

NATIONAL REGISTER OF HISTORIC PLACES
INVENTORY -- NOMINATION FORM

FOR NPS USE ONLY

RECEIVED

DATE ENTERED

CONTINUATION SHEET Federal Street

ITEM NUMBER

A

PAGE

14

Federal Street National Register District

Ownership Data & Importance Rating

<u>Property Address (SAM#)</u>	<u>Importance Rating*</u>	<u>Ownership</u>
2 Federal Street (26-413) ^o	1	County of Essex 32 Federal Street Salem, Mass. 01970
0 Federal Street (26-413) ^o	1	County of Essex see above
0 Federal Street (26-413) ^o	1	County of Essex see above
4 Federal Street (26-412)	1	First Baptist Church 54 Federal Street Salem, Mass. 01970
3 Federal Street (26-411)	2	Federal Street Trust Edward Mallo et al, Trs. 6 Walsh Avenue Peabody, Mass. 01960
0 Federal Street (26-410)	1	Reuben Realty Trust David Rifkin et al, Trs. 60 Federal Street Salem, Mass. 01970
0 Federal Street (26-409)	2	Federal Street Trust see 58 Federal Street
0 Federal Street (26-414)	1	Federal Street Trust see above
0 Federal Street (26-415)	1	Federal Street Trust see above
0 Federal Street (26-416)	2	Federal Street Trust see above
0 Federal Street (26-417)	2	Robert B. Bowman 40 Wisteria Street Salem, Mass. 01970