

Traffic proposals for new courthouse.

Assuming the east ramps are eliminated to allow for the construction of the new courthouse on Federal Street.

Graphics show the Earthtech proposal as well as others developed by Salem residents.

5/19/2007 - 6/30/2007

Existing
5/19/2007

 traffic light  pedestrian light

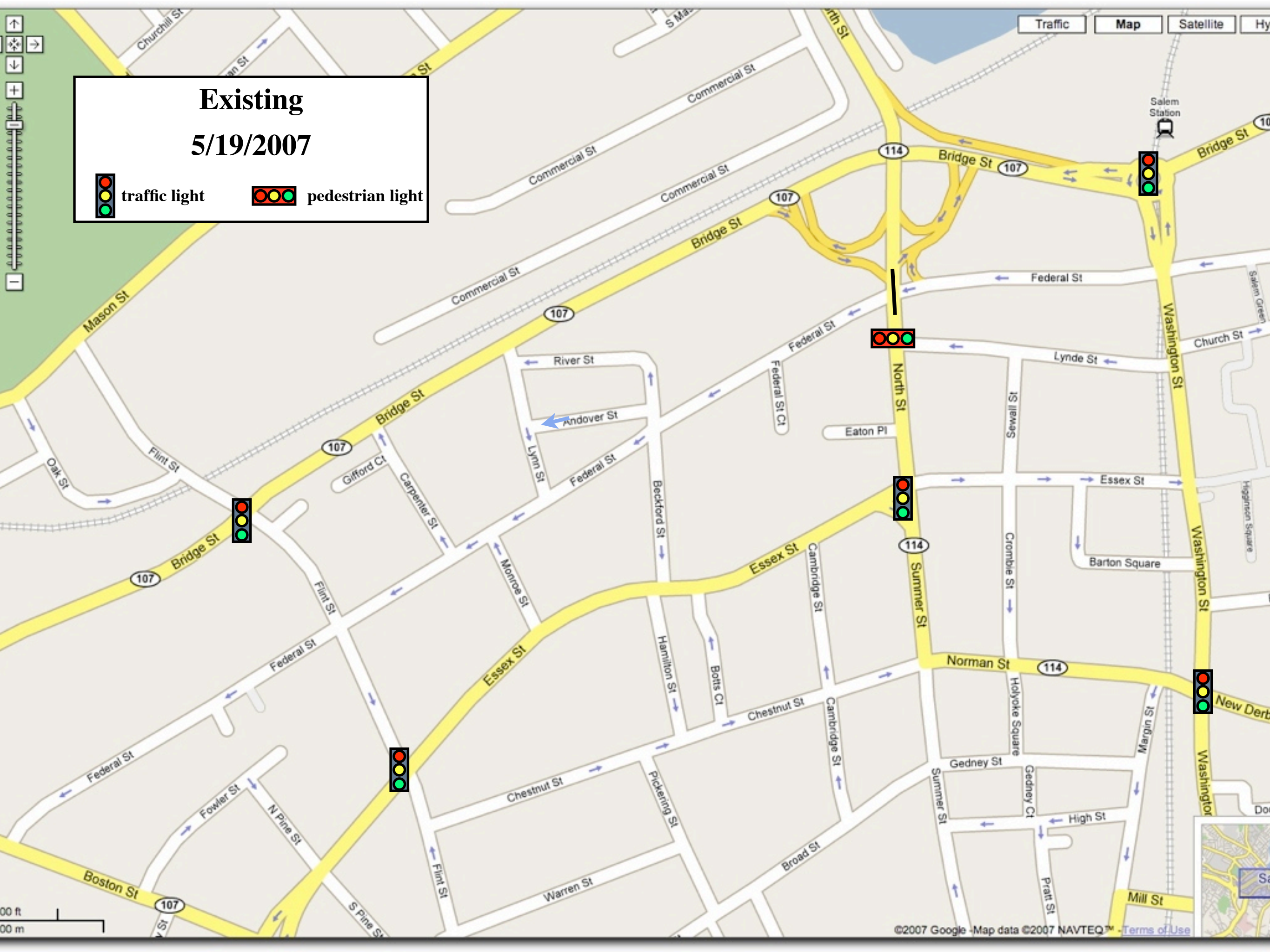

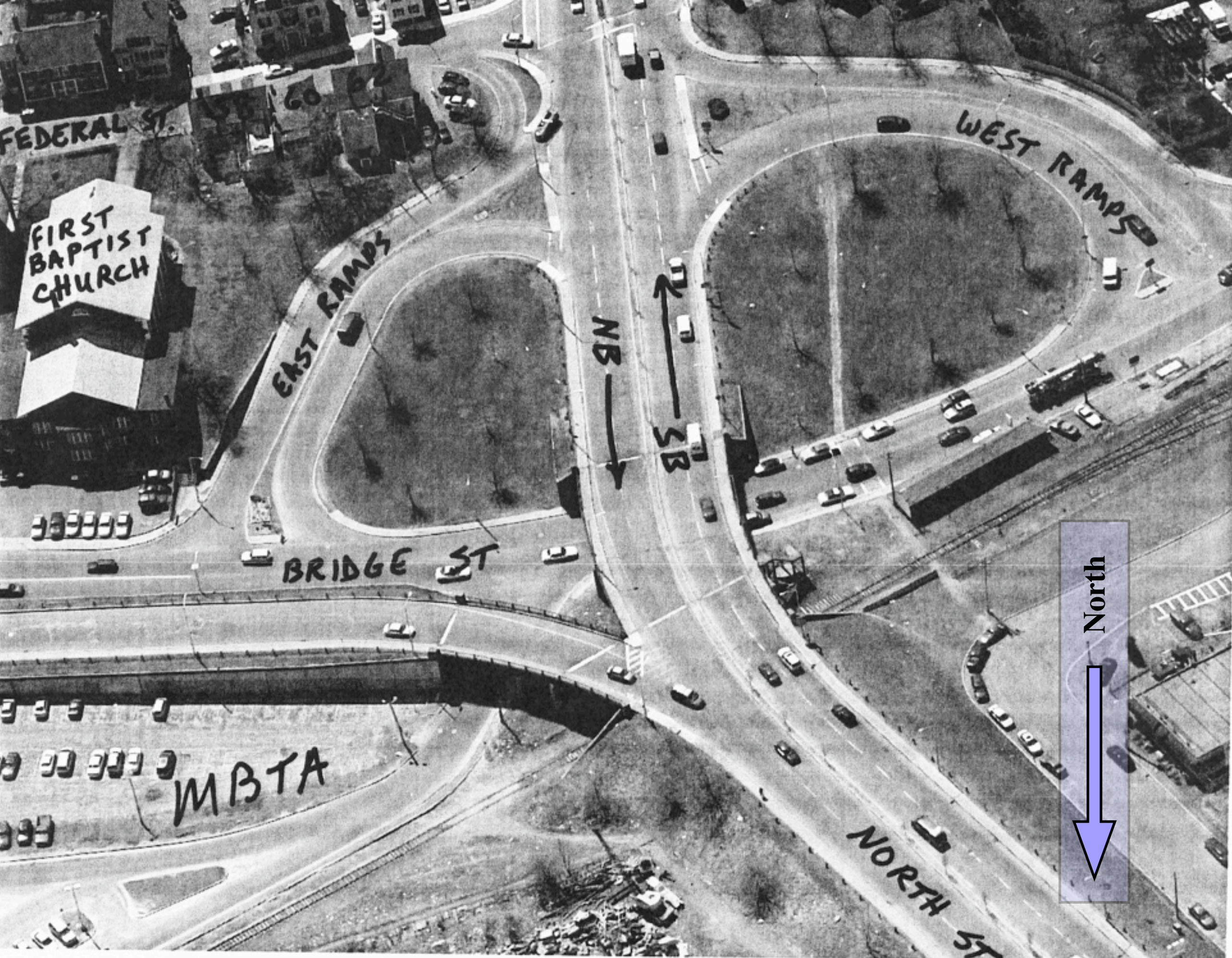

FEDERAL ST

FIRST
BAPTIST
CHURCH

EAST RAMPS

WEST RAMPS

NB

SB

BRIDGE ST

MBTA

North

NORTH ST

Court Reconfiguration
5/19/2007
Changes ←



Eliminate east ramps, expand west ramps,
signaled left turn at new west ramp



STEEL W BEAM HIGHWAY GUARD

STA 88+00 (CONNECT TO EXIST.) TO

North

DRAINAGE DETAILS

SEE BELOW

WATER SUPPLY ALTERATIONS

NONE

TRAFFIC SIGNAL CONDUIT

SEE BELOW

SALEM NORTH ST (RTE 114)				
STATE	FED. AID PROJ. NO.	FISCAL YEAR	SHEET NO.	TOTAL SHEETS
MASS	57F-00154(40) X	2006	07114	88
PROJECT FILE NO. 80323				

GENERAL PLAN

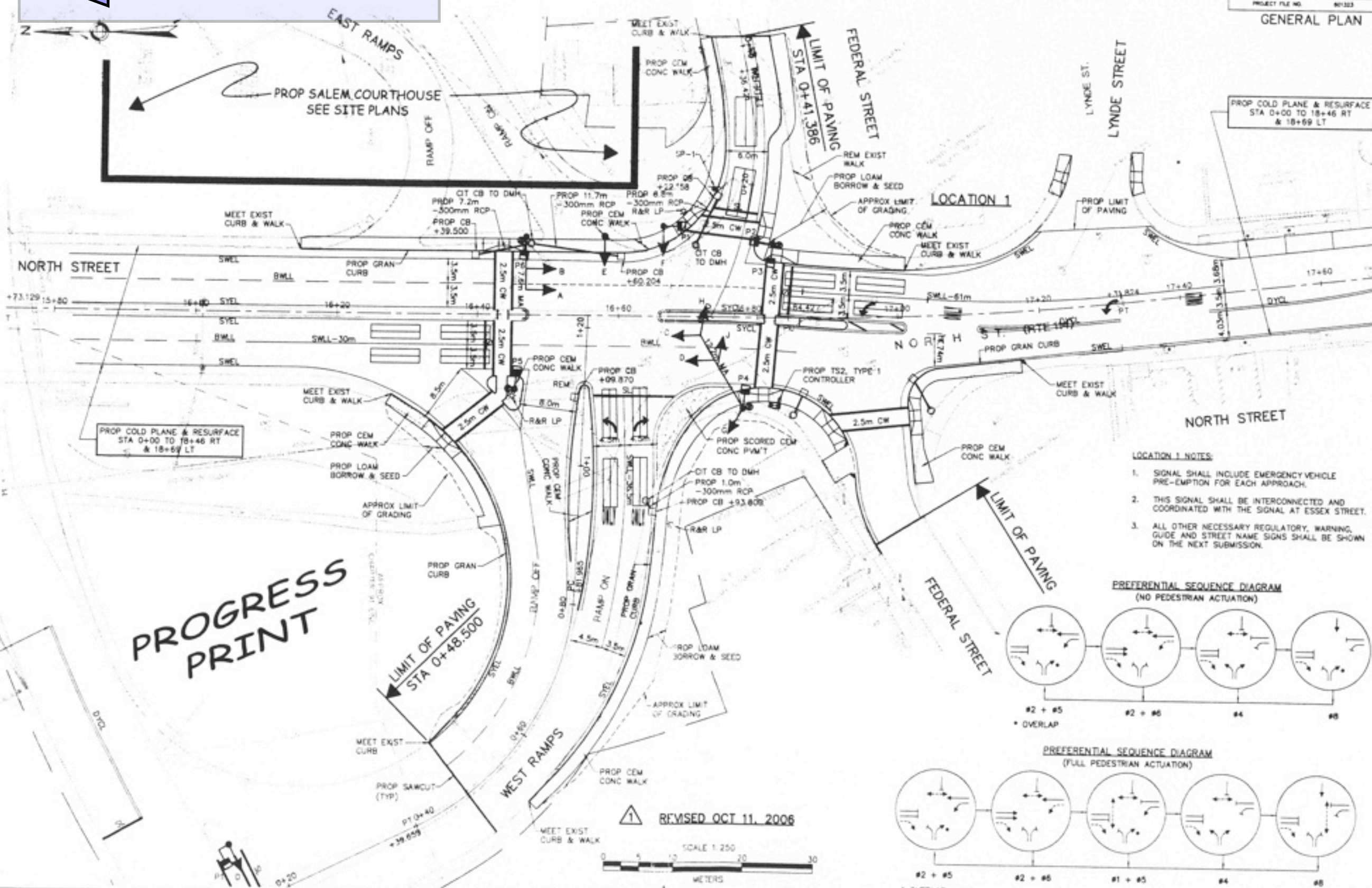

PROP COLD PLANE & RESURFACE STA 0+00 TO 18+46 RT & 18+69 LT

PROP COLD PLANE & RESURFACE STA 0+00 TO 18+46 RT & 18+69 LT

PROGRESS PRINT

- LOCATION 1 NOTES:**
1. SIGNAL SHALL INCLUDE EMERGENCY VEHICLE PRE-EMPTION FOR EACH APPROACH.
 2. THIS SIGNAL SHALL BE INTERCONNECTED AND COORDINATED WITH THE SIGNAL AT ESSEX STREET.
 3. ALL OTHER NECESSARY REGULATORY, WARNING, GUIDE AND STREET NAME SIGNS SHALL BE SHOWN ON THE NEXT SUBMISSION.

PREFERENTIAL SEQUENCE DIAGRAM (NO PEDESTRIAN ACTUATION)

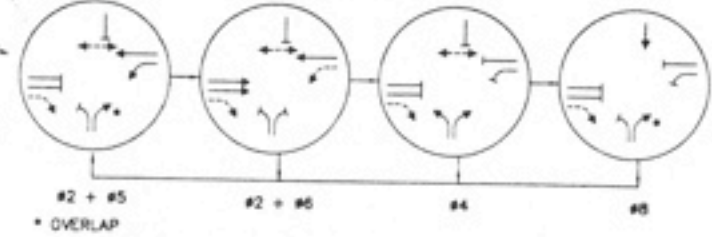

PREFERENTIAL SEQUENCE DIAGRAM (FULL PEDESTRIAN ACTUATION)

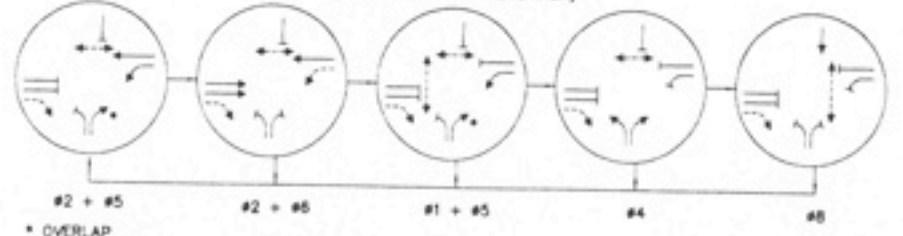

REVISED OCT 11, 2006



SEE SITE PLANS

North

Traffic Light (Typ)

LOCATION

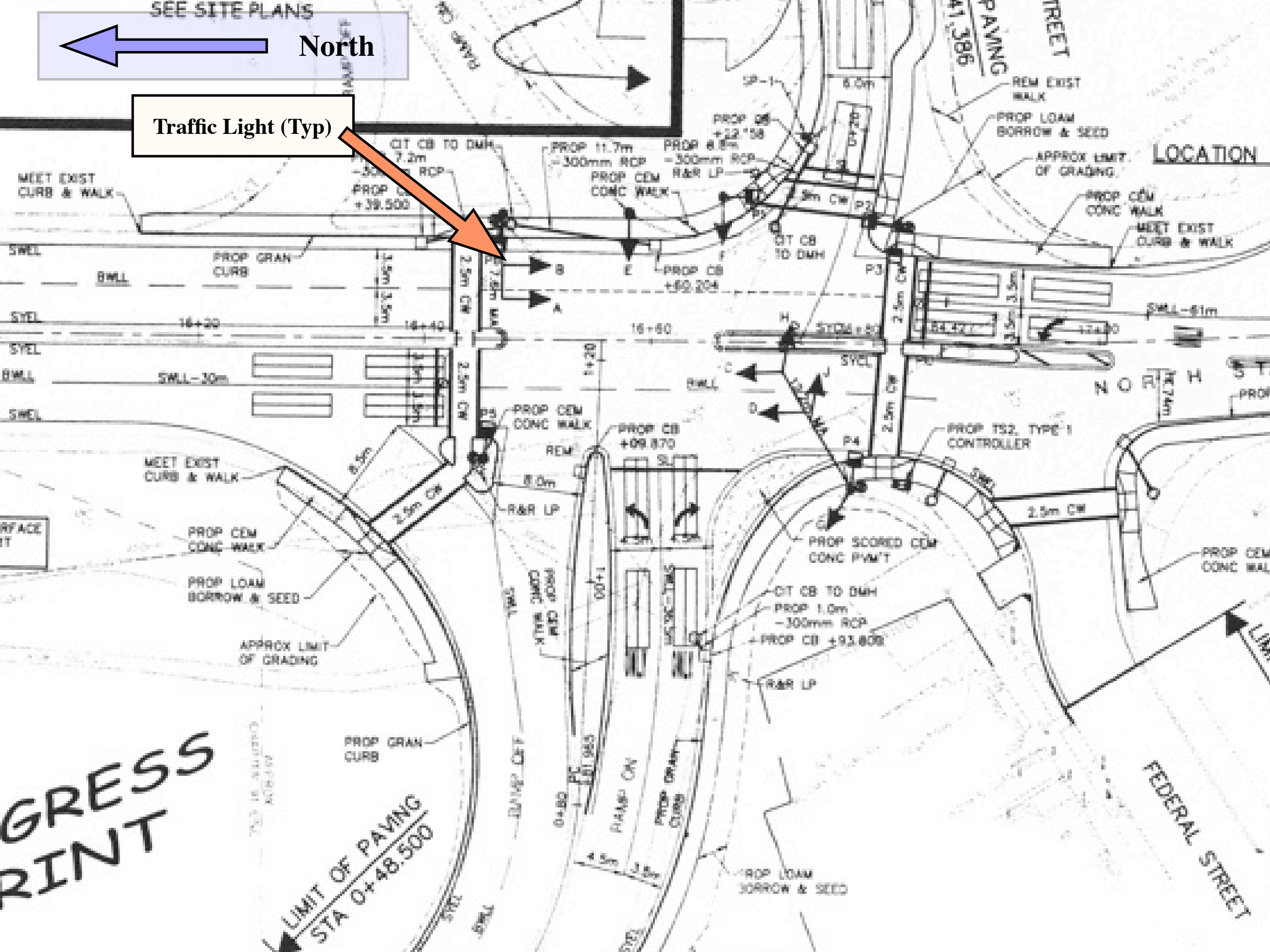

GRESS
RINT

LIMIT OF PAVING
STA 0+48.500

FEDERAL STREET

PROP SALEM COURTHOUSE
SEE SITE PLANS

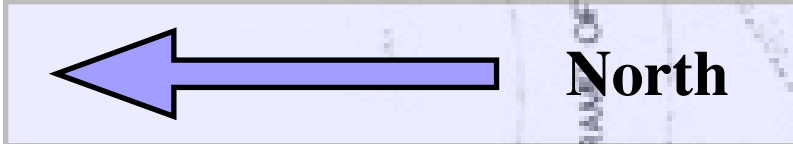

LOCATION 1

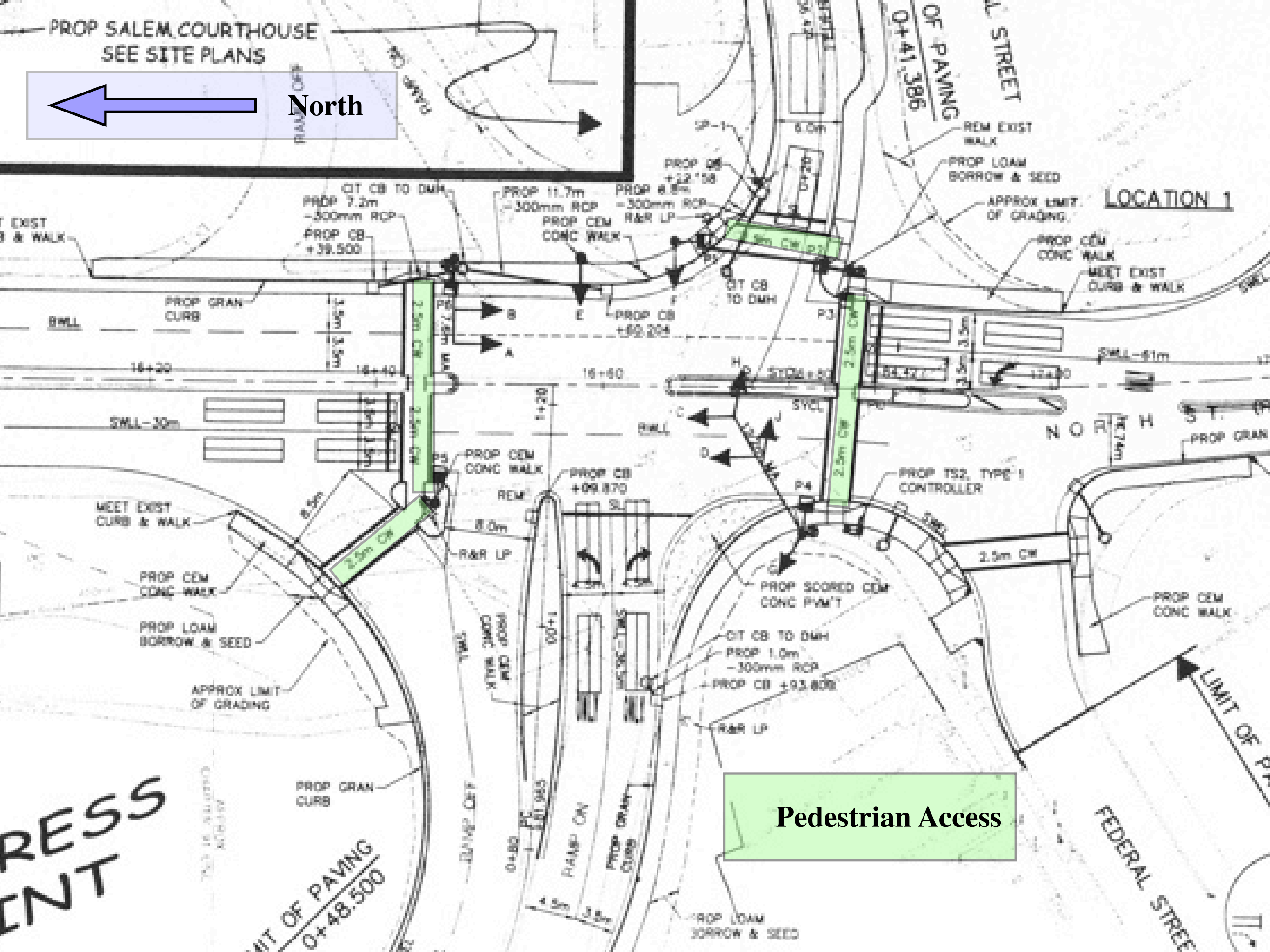

Pedestrian Access

RESS
INTA

LIMIT OF PAVING
0+48.500

FEDERAL STREET

LIMIT OF PAVING

STREET
OF PAVING
0+41.386

BWLL

16+20

SWLL-30m

PROP GRAN CURB

PROP 7.2m
-300mm RCP
PROP CB
+39.500

PROP 11.7m
-300mm RCP
PROP CEM
CONC WALK

PROP 8.8m
-300mm RCP
PROP R&R LP

PROP LOAM
BORROW & SEED

APPROX LIMIT
OF GRADING

PROP CEM
CONC WALK

MEET EXIST
CURB & WALK

PROP CB
+49.204

16+60

16+80

BWLL

SYCL

STDA+50

SYCL

PROP TS2, TYPE 1
CONTROLLER

MEET EXIST
CURB & WALK

PROP CEM
CONC WALK

PROP LOAM
BORROW & SEED

APPROX LIMIT
OF GRADING

PROP GRAN
CURB

DAMP CUT

PROP CEM
CONC WALK

PROP GRAN
CURB

PROP GRAN
CURB

PROP SCORED CEM
CONC PAVT

PROP 1.0m
-300mm RCP
PROP CB
+93.808

R&R LP

PROP LOAM
BORROW & SEED

PROP CEM
CONC WALK

LIMIT OF PAVING

GENERAL PLAN
TREE REPLACEMENT PLAN



PROP SALEM COURTHOUSE
SEE SITE PLANS

LIMIT OF PAVING
STA 0+41.386

LOCATION 1

PROP C&G PLANE & RE-SURFACE
STA 0+30 TO 18+41.41
& 18+57.17

NORTH STREET

PROGRESS
PRINT

PROPOSED TREE REMOVALS (6)

PROPOSED REPLACEMENT TREES (6)

LIMIT OF PAVING
STA 0+48.500

LIMIT OF PAVING

PLANTING NOTES
1. TREES PLANTED SHALL BE 3 - 3 1/2" (80-90MM)
LITTLELEAF LINDEN
2. LOCATIONS SHALL BE STAKED IN THE FIELD FOR
FINAL APPROVAL BY THE ENGINEER

PREFERENTIAL SEQUENCE DIAGRAM
(NO PEDESTRIAN ACTUATION)



PREFERENTIAL SEQUENCE DIAGRAM
(FULL PEDESTRIAN ACTUATION)

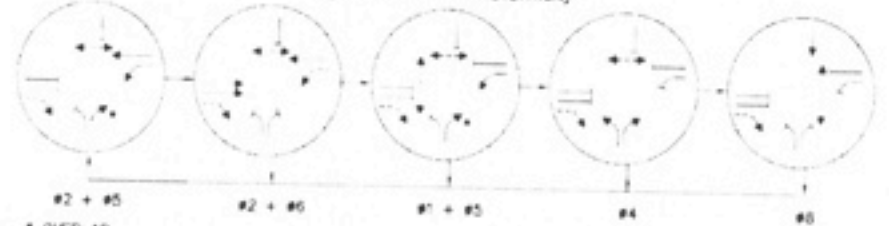

11/18/10

**Court Reconfiguration
Flow Change #1
5/19/2007**
Changes = 

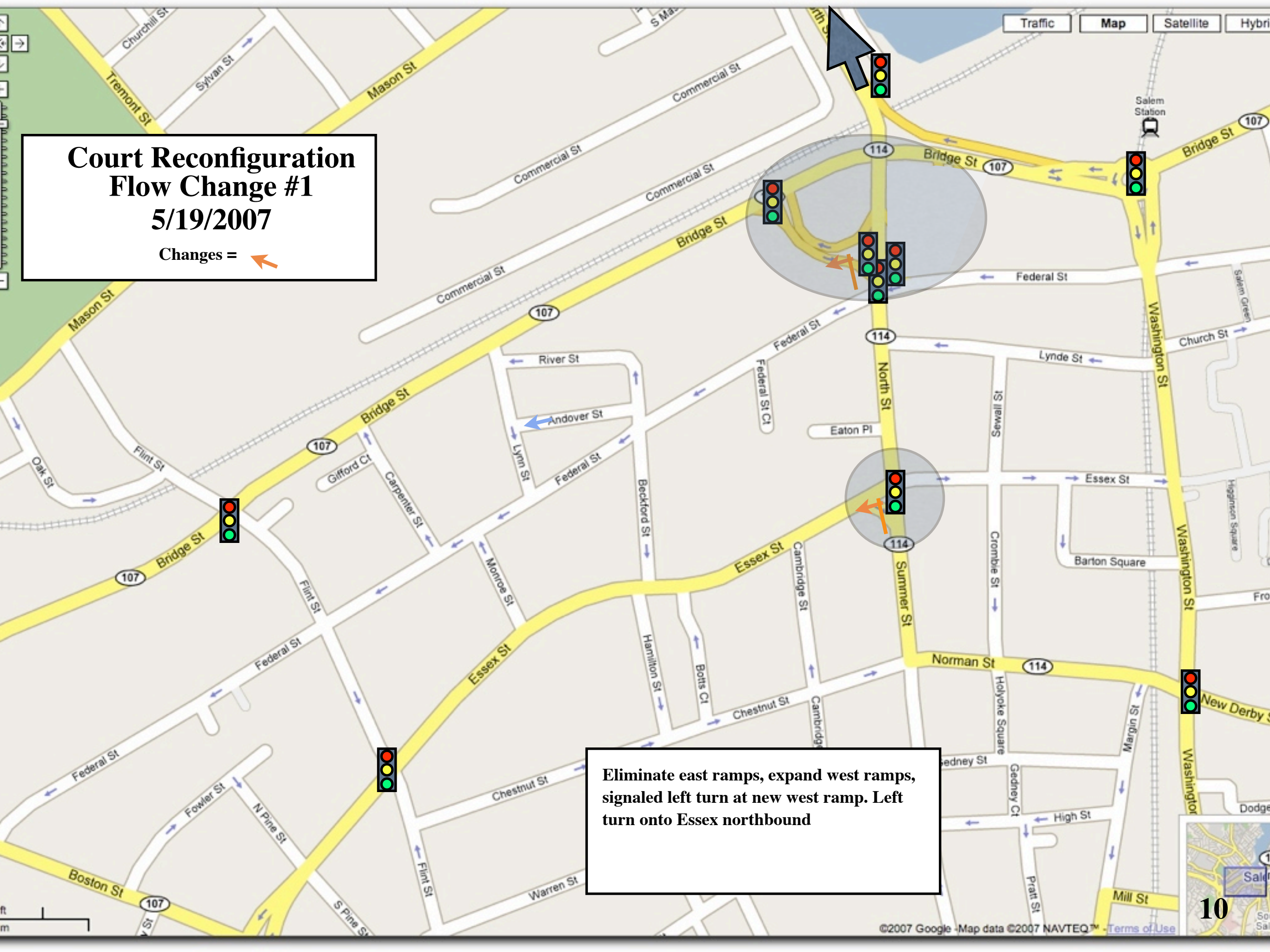

**Eliminate east ramps, expand west ramps,
signaled left turn at new west ramp. Left
turn onto Essex northbound**



Court Reconfiguration Flow Change #2 5/19/2007

Changes ←

Eliminate east ramps, expand west ramps,
signaled left turn at new west ramp,
Reverse part of Federal Street, Becford
Street. Reverse one way on Flint

Traffic Reconfiguration

6/28/2007

Scheme J

Changes



Eliminate east ramps, permit two way traffic on Federal Street in front of courts



Traffic Reconfiguration 6/28/2007 Scheme K

Changes ←

Eliminate east ramps, permit two way traffic on Federal Street in front of courts, permit left turn onto Essex northbound, allow two way traffic on Chestnut Street.

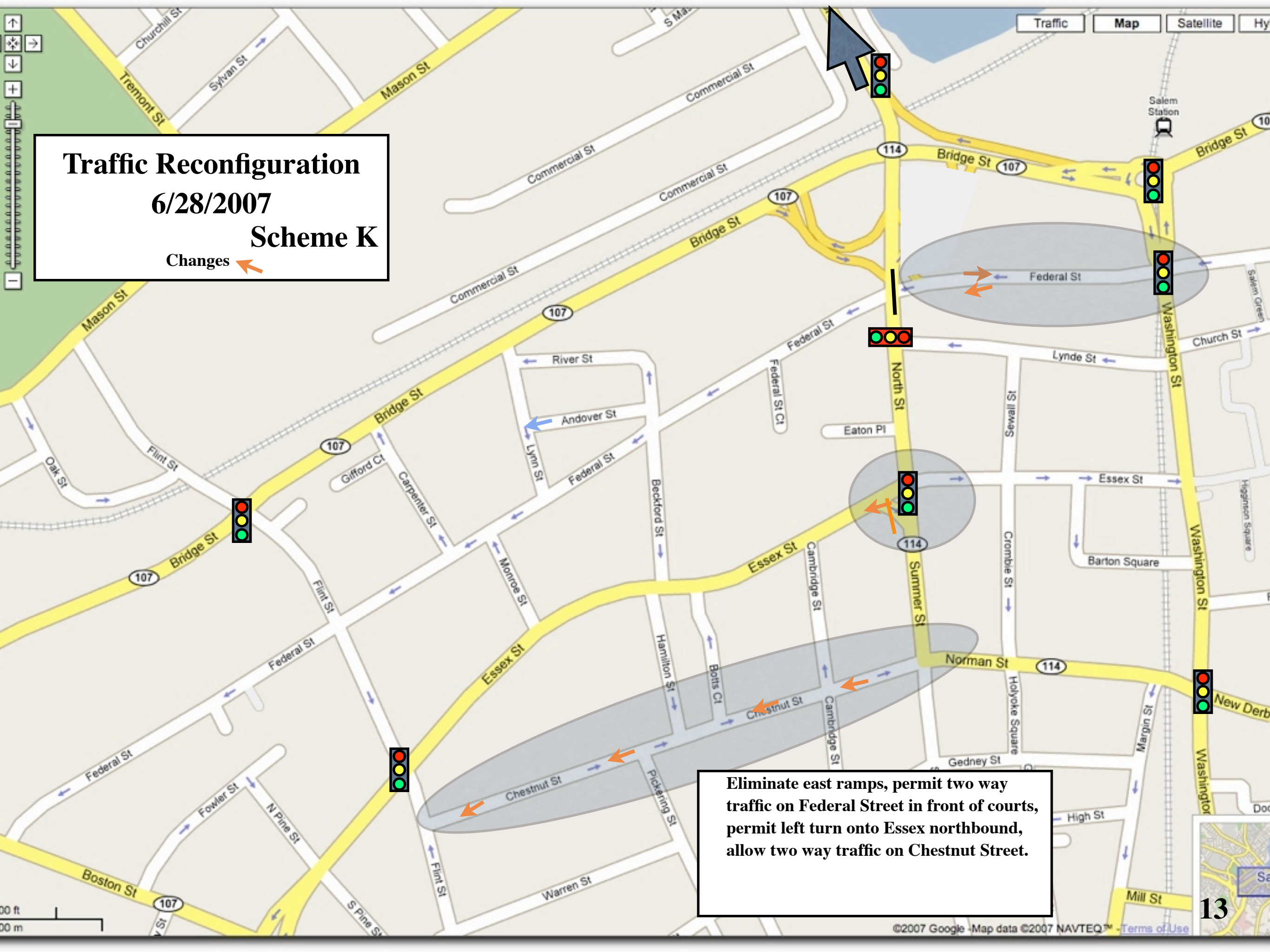

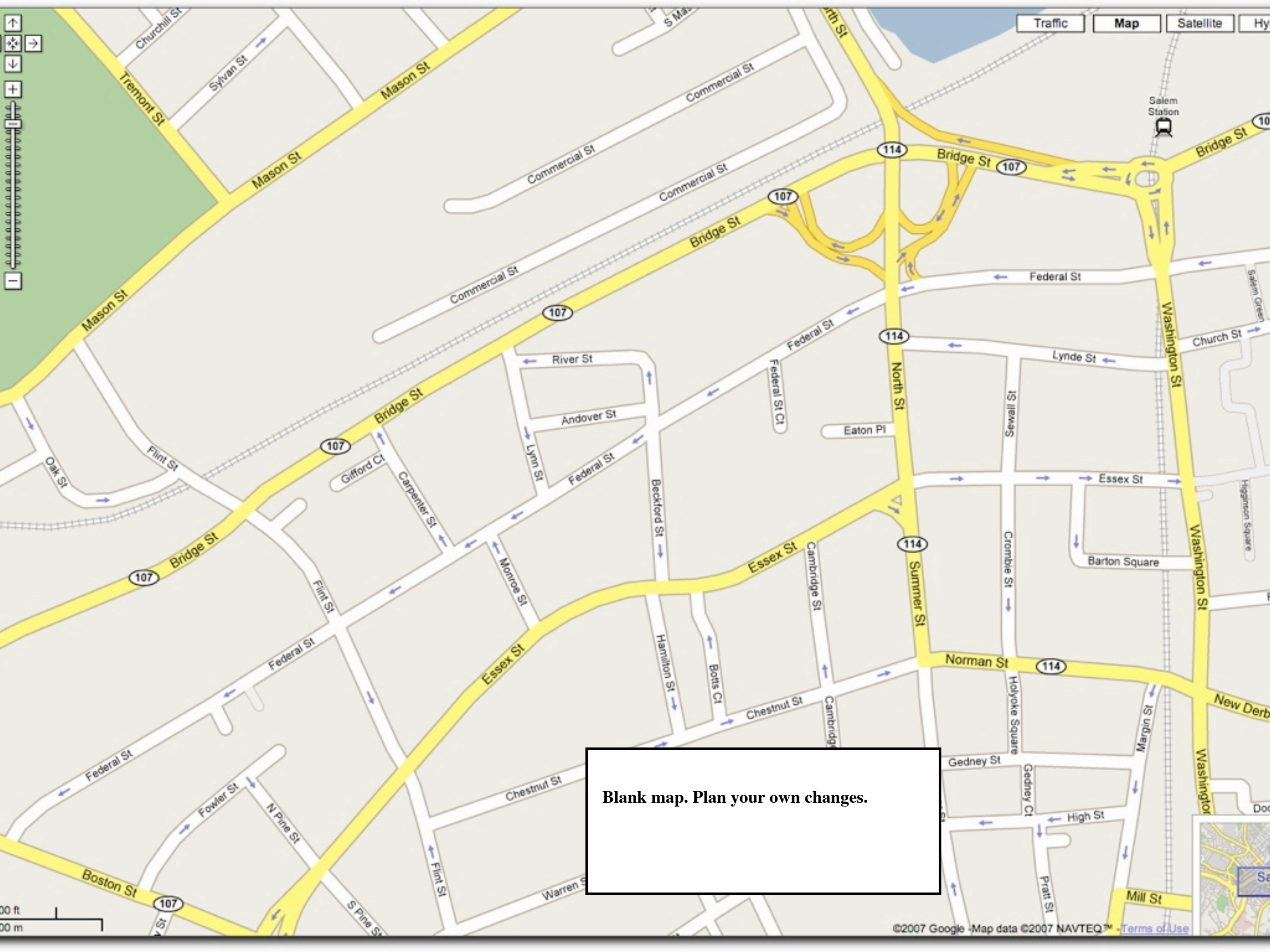

Blank map. Plan your own changes.

Traffic Reconfiguration

6/28/2007

Changes **Scheme M**

Eliminate east ramps, west ramps. Remove viaduct and bring Bridge/North Streets down to grade.

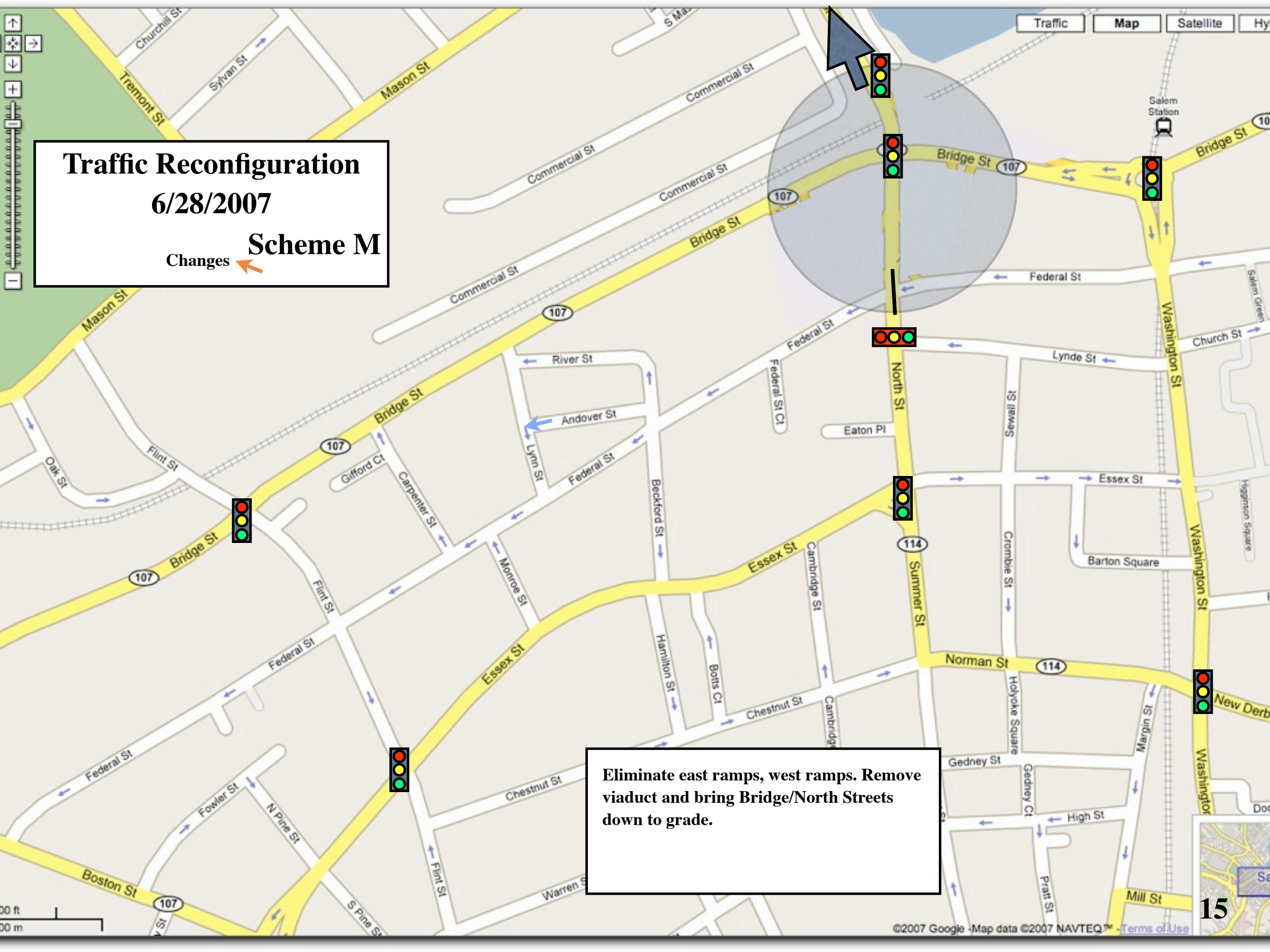

Traffic Reconfiguration

6/28/2007

Scheme N

Changes



Eliminate east ramps, reverse Lynde Street

Traffic Reconfiguration

6/28/2007

Changes **Scheme O**

Eliminate east ramps, reverse traffic on Federal Street in front of courts, Reverse one way on part of Federal and Beckford.

Traffic Reconfiguration 6/28/2007 Scheme P

Changes ←

Eliminate east ramps, permit two way traffic on Federal Street in front of courtsmake North Street one way south, Norman Street one way east, Washington Street one way north

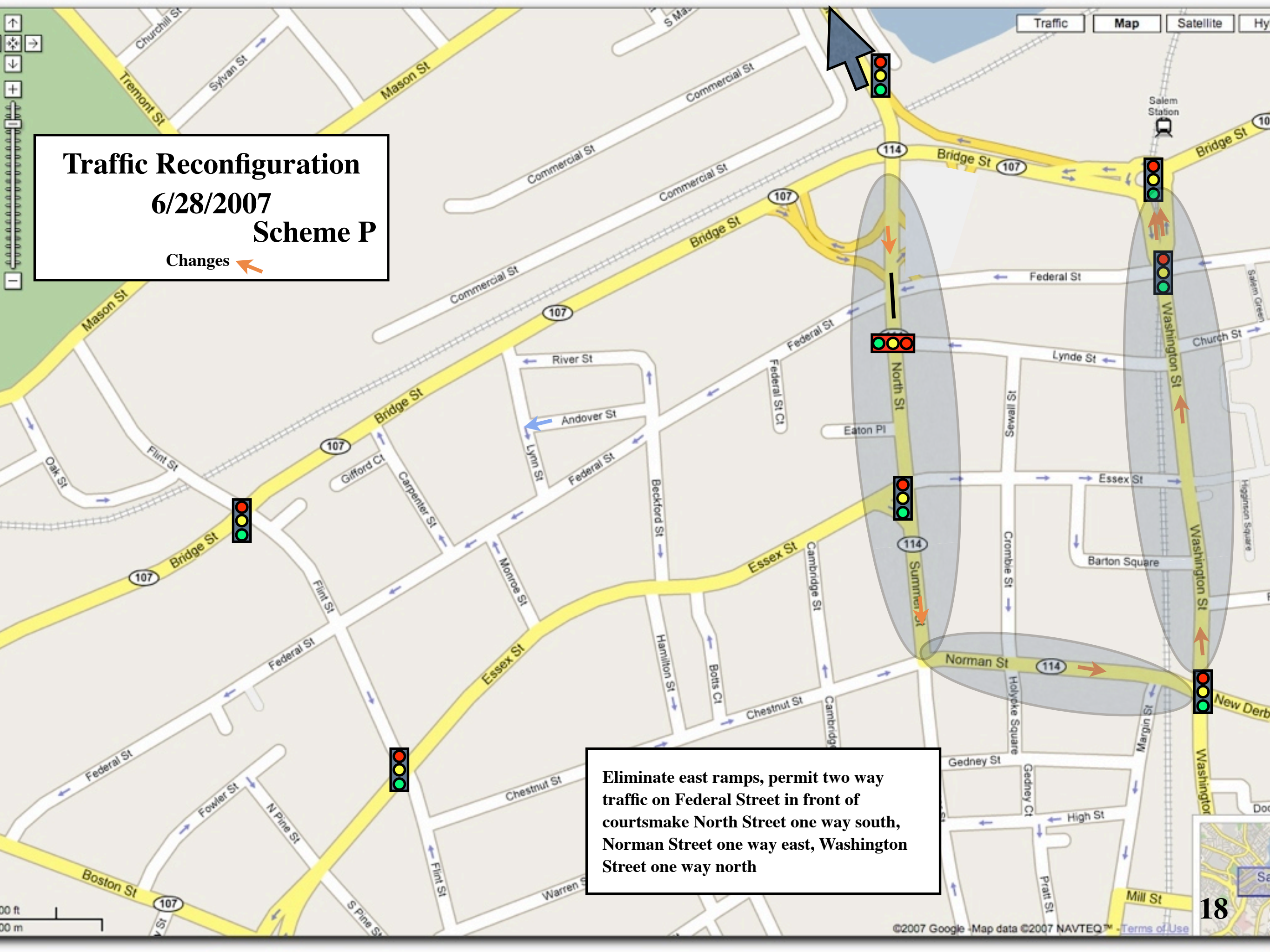

Traffic Reconfiguration
6/28/2007
Scheme Q
Changes ←

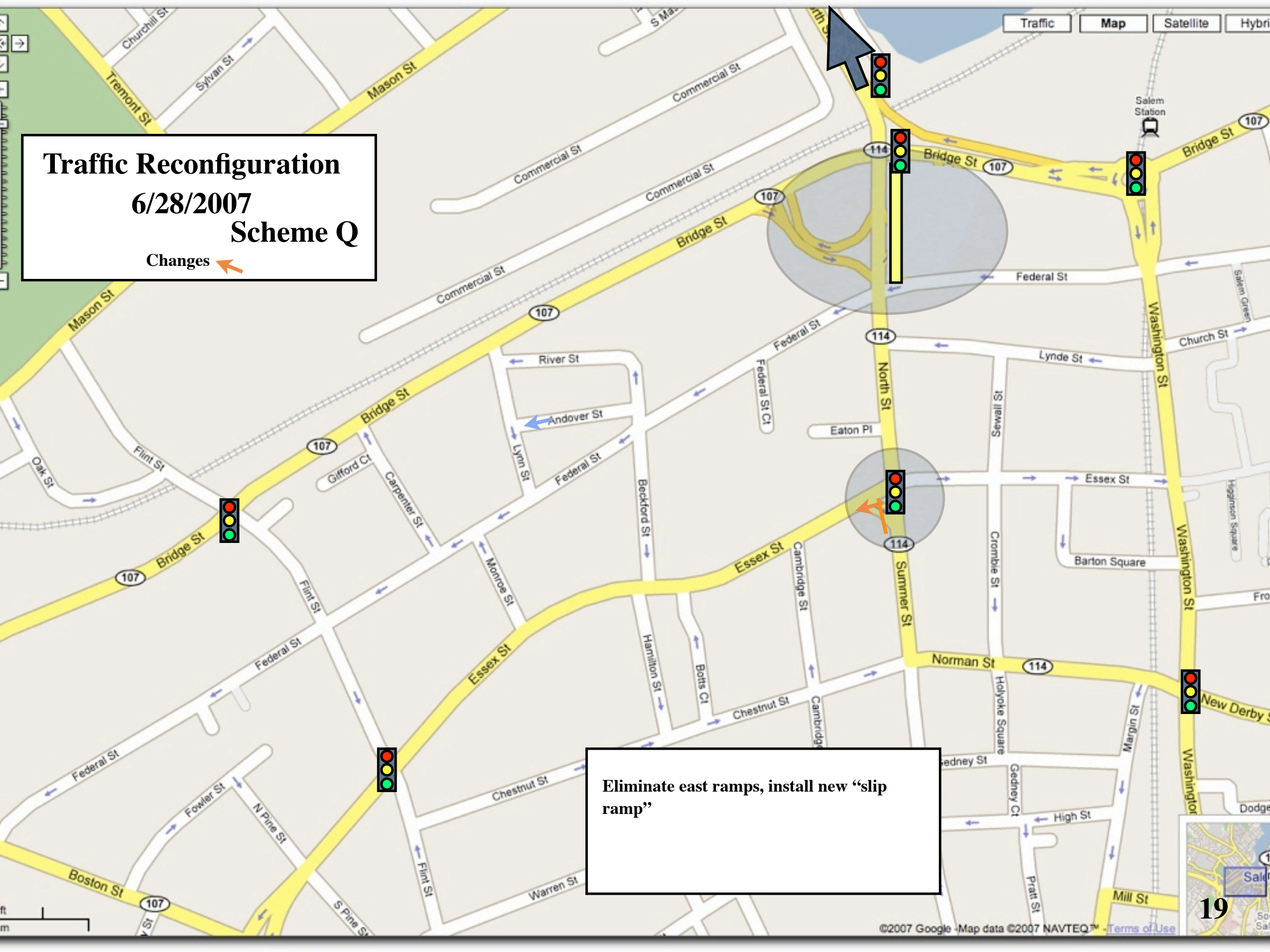

Eliminate east ramps, install new "slip ramp"

